KIT PART NUMBER 4320021
INSTRUCTIONS FOR INSTALLING THE COVER POWER PANEL

CHECK THE PARTS RECEIVED IN THE KIT WITH THE PARTS LIST IN THESE INSTRUCTIONS. IF ANY PARTS ARE MISSING, CONTACT THE NATIONAL VENDORS PARTS DEPARTMENT IMMEDIATELY.

Read these instructions carefully before installing the kit.
Keep these instructions for part numbers and for future reference.

THIS KIT CONTAINS THE FOLLOWING :

PART NUMBER	DESCRIPTION	QUANTITY
4324047	COVER-POWER PANEL	1
4320023	KIT-INSTRUCTIONS	1

1. Disconnect power from merchandiser at wall outlet.
2. Remove power panel from machine.
3. Remove the two upper screws that secure the fan shroud in place and retain the screws (See figure 1).
4. Place the power panel cover part #4324047 next to the condenser coil aligning the holes where the two screws were removed.
5. Using the two screws that were removed earlier, secure the power panel cover to the condenser.
6. Install the power panel back in the machine. Make sure all connectors are securely fastened.
7. Restore power back to the merchandiser.

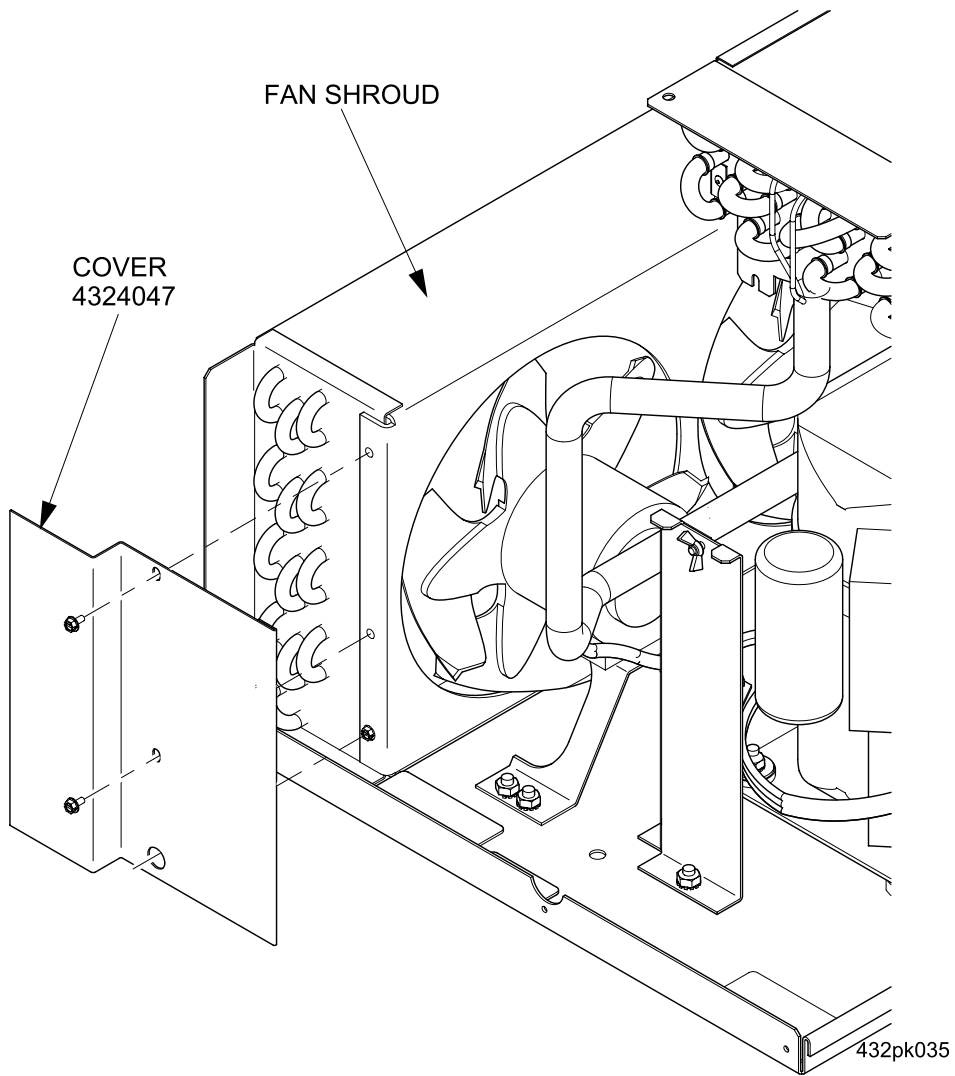

Figure 1